

AREA SCHEDULE	M <sup>2</sup>
TOTAL USABLE	6789,04
TOTAL COMMON	282,79
TOTAL REMOTE COMMON	139,87
TOTAL RENTABLE	7211,70
USABLE BASEMENT FLOOR AREA	2325,38
COMMON AREA	0,00
REMOTE COMMON AREA	47,91
RENTABLE BASEMENT FLOOR AREA	2373,29
USABLE GROUND FLOOR AREA	2231,48
COMMON AREA	145,56
REMOTE COMMON AREA	45,97
RENTABLE GROUND FLOOR AREA	2423,01
USABLE FIRST FLOOR	2232,18
COMMON AREA	137,23
REMOTE COMMON AREA	45,99
RENTABLE FIRST FLOOR	2415,40

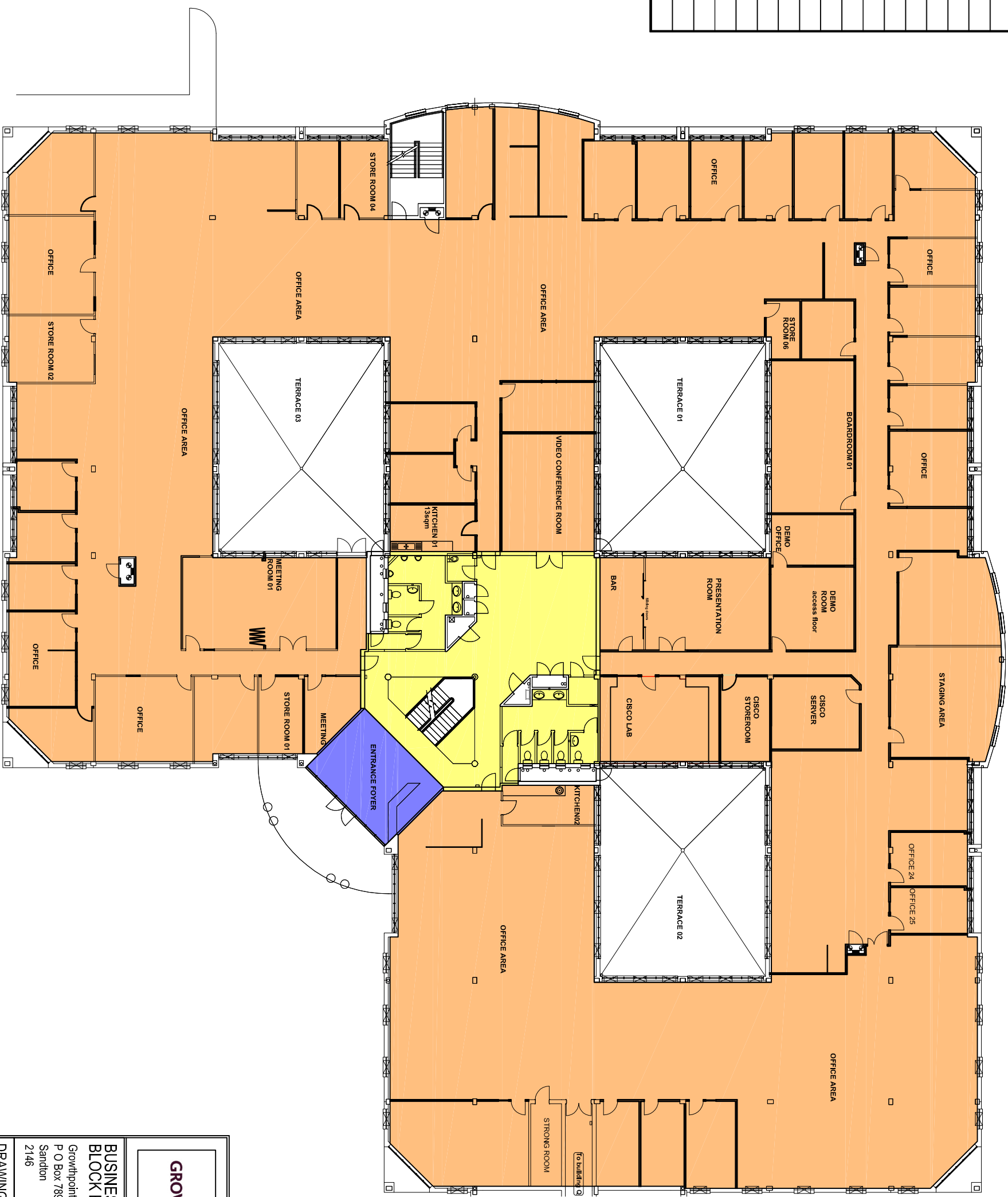

GROUND FLOOR PLAN

**GROWTHPOINT**  
PROPERTIES



**BUSINESS CONNECTION  
BLOCK E**  
Growthpoint Properties  
P O Box 78949  
Sandton  
2146

**DRAWING  
GROUND  
FLOOR PLAN**

SCALE: 1:250  
DRAWN BY: D. RHNS  
DATE: SEPTEMBER 2014